

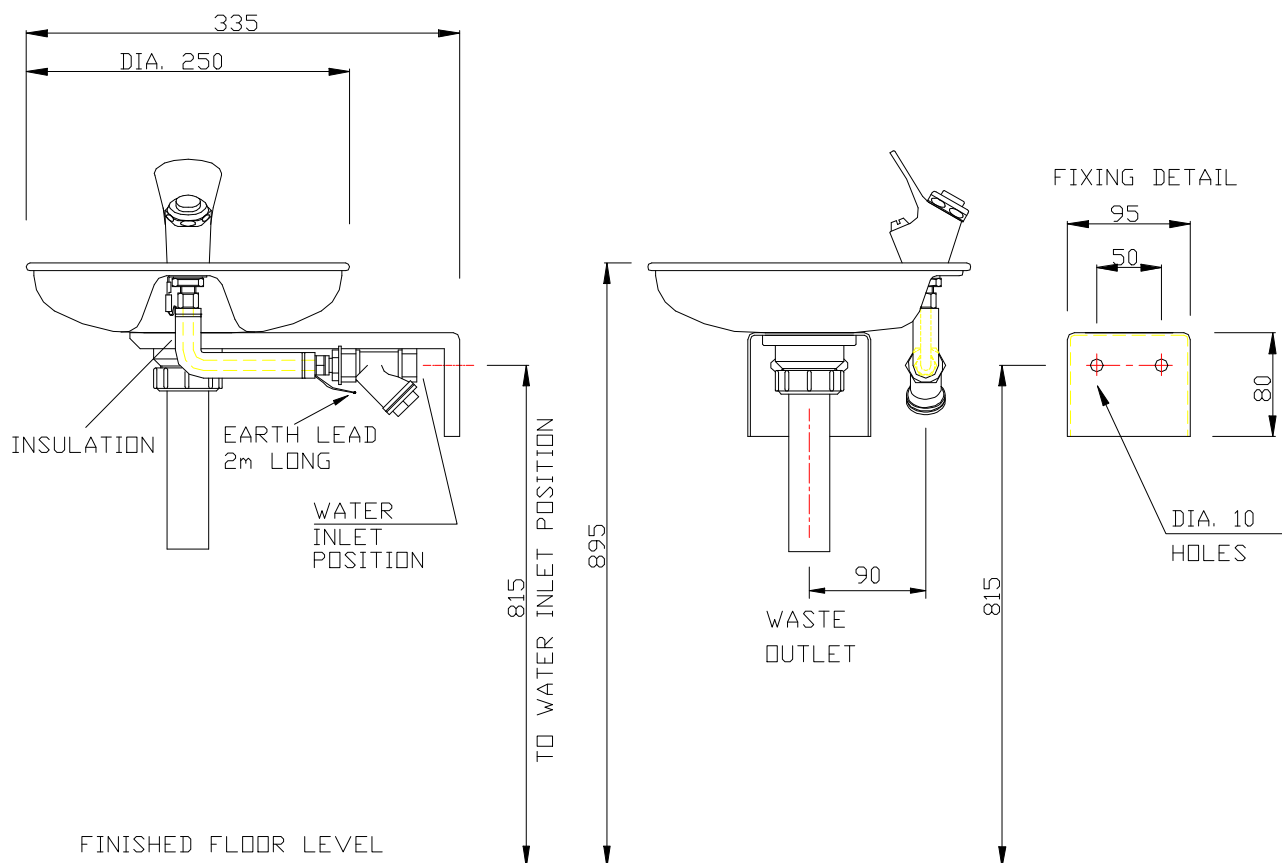

11-17 POWERSCROFT ROAD  
SIDCUP, KENT. DA14 5NH  
Tel: GB: +44 (0) 208 302 4035  
Fax: GB: +44 (0) 208 302 8933

## Technical Data Sheet



### DRINKING FOUNTAIN MODEL WF114

A stainless steel drinking fountain with a heavy chrome plated self-regulating bubbler. It is easily installed and ideal for public buildings, hospitals, offices, nursing homes, schools and sporting centres.

#### CONSTRUCTION:

Heavy gauge basin mounted on a stainless steel bracket.

#### SERVICES:

Water inlet: 15mm (1/2" BSP) brass inline strainer.

Waste: 32mm multi-fit trap.

#### PACKAGING:

Dimensions: 510 x 285 x 285 mm

Weight: 3 kgs.

# CAUTION

## Drinking Fountains On Outside Locations

During winter when temperatures may reach freezing point, it is advisable to drain the water system to prevent damage to the bubbler cartridge.

Ideally, a drain-cock should be fitted downstream of the shut-off cock and before the fountain.

### To drain the system:-

1. Close off the shut-off cock and drain off at the drain-cock holding the push button in the open position until all the water has drained away.
2. Close off the drain-cock.

If a drain-cock is not available, the water can be drained in the same manner at the removable plug on the line strainer located inside the fountain.

Please note that frequent use of this item for draining purposes can lead to leakages and it should be considered as a temporary measure until such time that a drain-cock can be fitted.



### *Water Flow Adjustment*

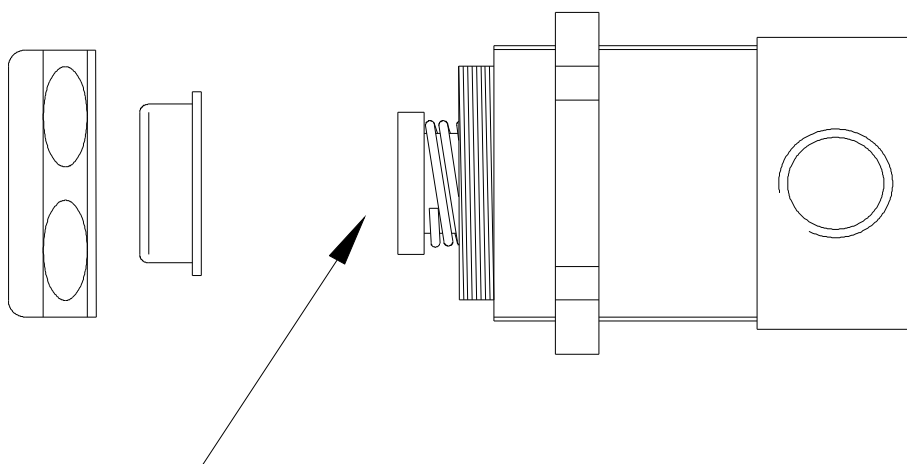

**ADJUST THE WATER FLOW BY ROTATING THE SLOT IN THE  
WHITE HEADED SCREW LOCATED IN THE PUSH BUTTON**