

## Technical Data Sheet

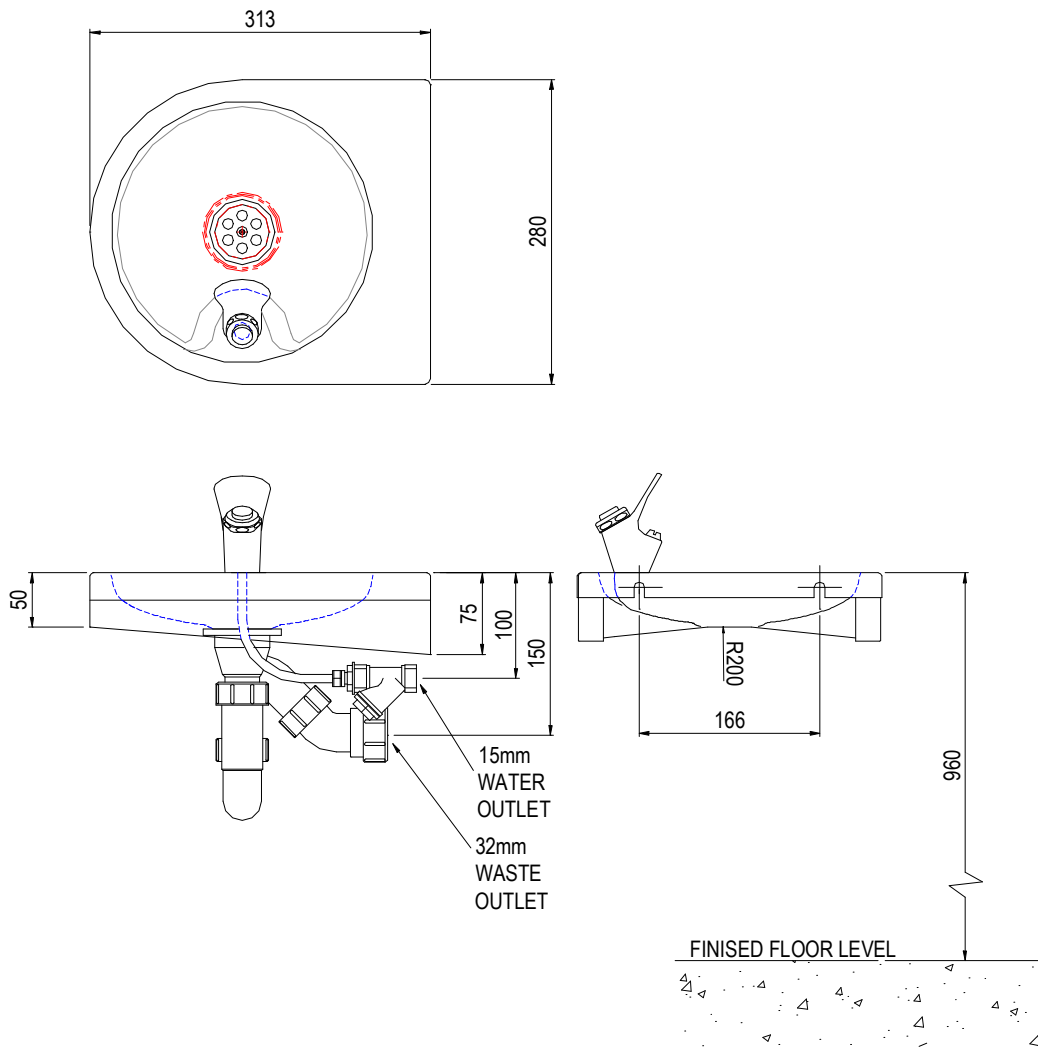

### DRINKING FOUNTAIN MODEL W231

A stainless steel drinking fountain with a heavy chrome-plated push button type self-regulating bubbler. With the option of fitting a glass filler instead of the bubbler, it is easily installed and ideal for factories and work places where it can be connected to a remote Hide-A-Way unit.

#### CONSTRUCTION:

Casing in brushed finish stainless steel with integral mounting points for easy installation.

#### SERVICES:

Water inlet: 15mm (1/2" BSP) brass line strainer.

Waste: 32mm multi-fit trap.

#### PACKAGING:

Dimensions: 14 x 36 x 36 cms

Weight: 3 kilos

# CAUTION

## Drinking Fountains On Outside Locations

During winter when temperatures may reach freezing point, it is advisable to drain the water system to prevent damage to the bubbler cartridge.

Ideally, a drain-cock should be fitted downstream of the shut-off cock and before the fountain.

### To drain the system:-

1. Close off the shut-off cock and drain off at the drain-cock holding the push button in the open position until all the water has drained away.
2. Close off the drain-cock.

If a drain-cock is not available, the water can be drained in the same manner at the removable plug on the line strainer located inside the fountain.

Please note that frequent use of this item for draining purposes can lead to leakages and it should be considered as a temporary measure until such time that a drain-cock can be fitted.



### *Water Flow Adjustment*

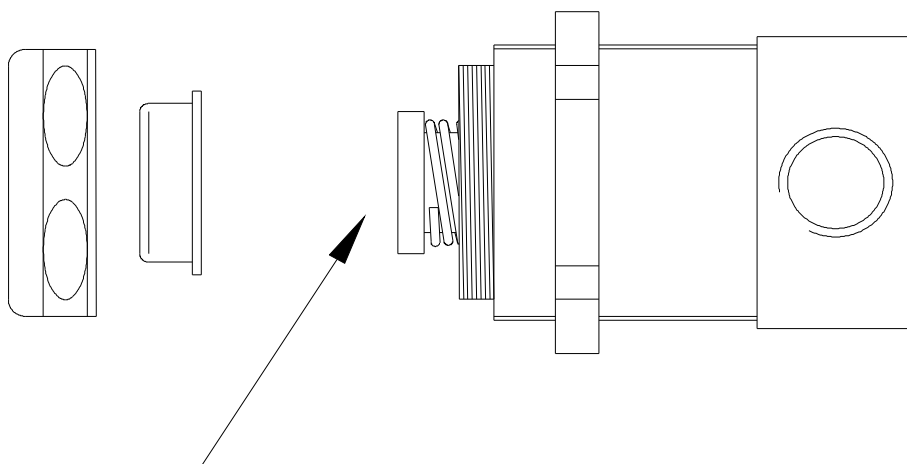

**ADJUST THE WATER FLOW BY ROTATING THE SLOT IN THE  
WHITE HEADED SCREW LOCATED IN THE PUSH BUTTON**