



# MAESTRO Pressure Coolers

11/17 Powerscroft Road, Sidcup, Kent. DA14 5NH

Telephone: 020 8302 4035 Fax: 020 8302 8933

**Maestro**

E-mail: [sales@maestrintl.co.uk](mailto:sales@maestrintl.co.uk)

Website: [www.maestrintl.co.uk](http://www.maestrintl.co.uk)

**Water Coolers\* Drinking Fountains\* Bottled Water Deliveries \* Accessories \* Sanitization**

## TECHNICAL DATA SHEET

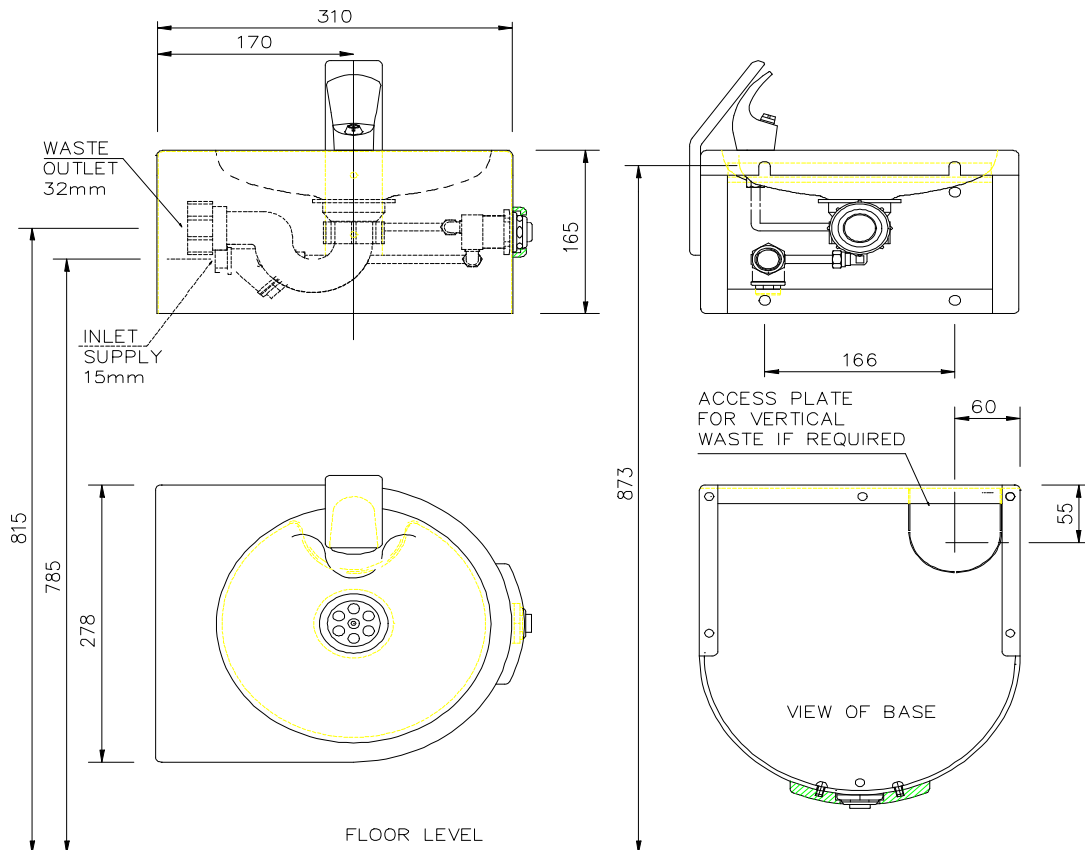

### DRINKING FOUNTAIN MODEL 56V

A stainless steel drinking fountain with a heavy chrome plated projector operated by a remote push button type self-regulating valve. It is easily installed and ideal for public buildings, schools and sports centres. The model 56V is easy to install with a high resistance to vandalism and corrosion.

#### CONSTRUCTION:

Casing in brush stainless steel with mounting plate and integral mounting for easy installation.

Access plate fixed with tamper proof screws. The push button regulator and projector are protected by thick steel guards.

#### SERVICES:

Water inlet: 15mm (1/2" BSP) brass line strainer.

Waste: 32mm multi-fit trap.

#### PACKAGING:

Dimensions: 350 x 350 x 280 mm

Weight: 6 kgs.

Specifications subject to change without notice



# CAUTION

## Drinking Fountains On Outside Locations

During winter when temperatures may reach freezing point, it is advisable to drain the water system to prevent damage to the bubbler cartridge.

Ideally, a drain-cock should be fitted downstream of the shut-off cock and before the fountain.

To drain the system:-

1. Close off the shut-off cock and drain off at the drain-cock holding the push button in the open position until all the water has drained away.
2. Close off the drain-cock.

If a drain-cock is not available, the water can be drained in the same manner at the removable plug on the line strainer located inside the fountain.

Please note that frequent use of this item for draining purposes can lead to leakages and it should be considered as a temporary measure until such time that a drain-cock can be fitted.



### *Water Flow Adjustment*

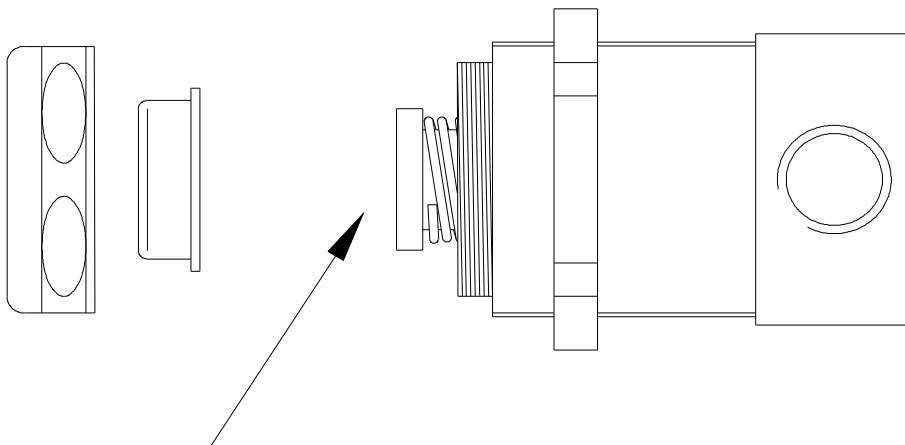

**ADJUST THE WATER FLOW BY ROTATING THE SLOT IN THE WHITE HEADED SCREW LOCATED IN THE PUSH BUTTON**