



**Maestro**

# MAESTRO Pressure Coolers

11/17 Powerscroft Road, Sidcup, Kent. DA14 5NH

Telephone: 020 8302 4035

Fax: 020 8302 8933

E-mail: [sales@maestrointl.co.uk](mailto:sales@maestrointl.co.uk)

Website: [www.maestrointl.co.uk](http://www.maestrointl.co.uk)

Water Coolers \* Drinking Fountains \* Bottled Water Deliveries \* Accessories \* Sanitization

## DRINKING FOUNTAIN MODEL S232

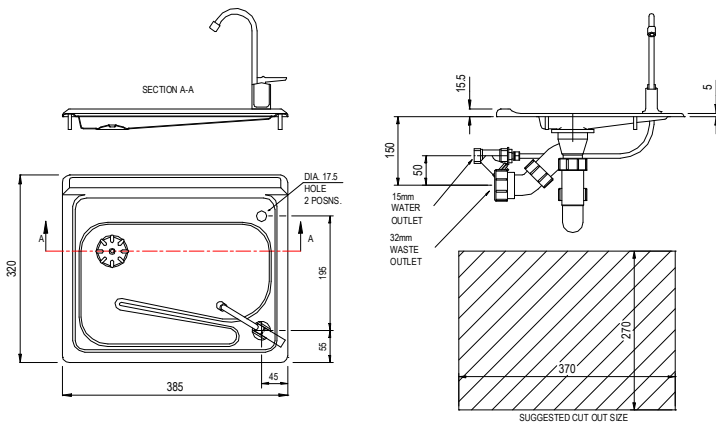

### Suggested Specification:

Contractor will supply surface-mounted drinking fountain constructed in heavy gauge stainless steel. The fountain will be supplied with a glass filler. The fountain will be Maestro model S232

### General Description:

A stainless steel drinking fountain with a heavy chrome-plated push button type self-regulating bubbler for mounting into a counter top. With the option of fitting a glass filler instead of the bubbler, it is easily installed and can easily be connected to a remote Hide-Away water cooler.

### Construction:

Finished in smooth satin finish stainless steel with integral mounting points for easy installation

### SERVICES:

Water inlet: 15mm (1/2" BSP) brass line strainer.  
Waste: 32mm multi-fit trap.

### PACKAGING:

Dimensions: 350 x 350 x 280 mm  
Weight: 3 kgs



Specifications subject to change without notice

