

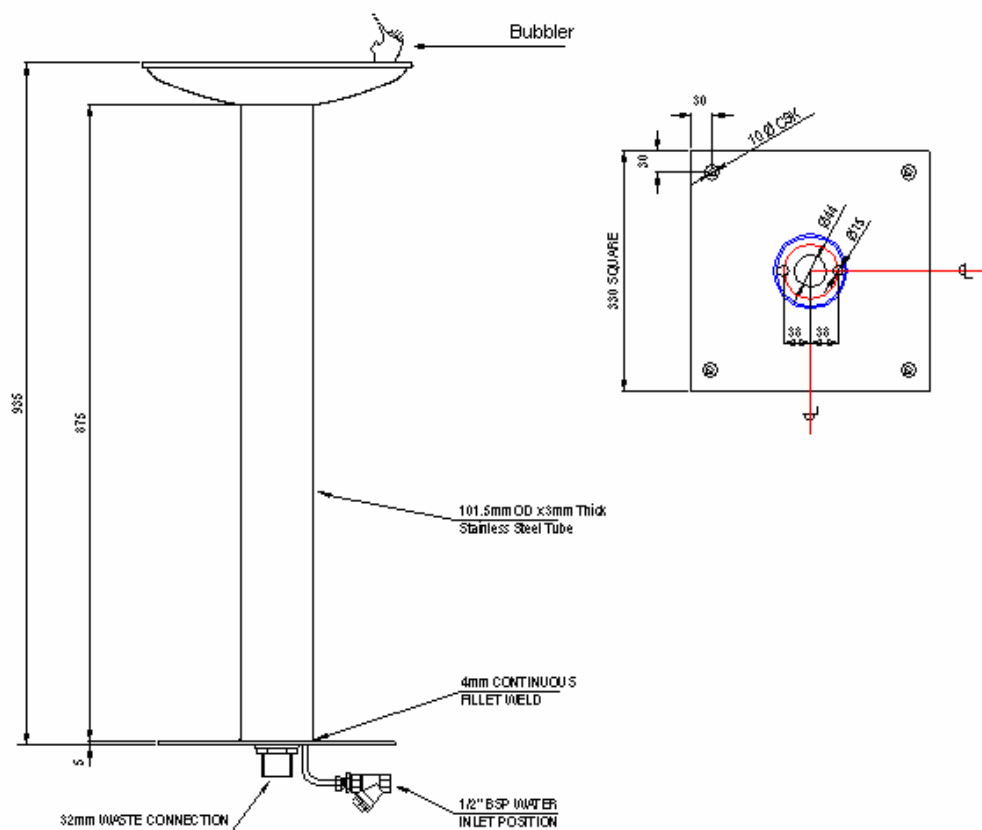

11-17 POWERSCROFT ROAD  
SIDCUP, KENT. DA14 5NH  
Tel: GB: +44 (0) 208 302 4035  
Fax: GB: +44 (0) 208 302 8933

## Technical Data Sheet



### DRINKING FOUNTAIN MODEL 778

An elegant stainless steel pedestal drinking fountain with a heavy chrome-plated self-regulating push button bubbler. The attractive sculptured bowl is mounted on a slim pedestal. It is ideal for hotel lobbies, sports centres and other areas where a stylish fountain is required.

#### CONSTRUCTION:

Receptor and pedestal is in heavy gauge stainless steel and the thick mounting footplate, which is normally concealed, is in heavy gauge steel.

#### SERVICES:

Water inlet: 15mm (1/2" BSP) brass line strainer.

Waste: 32mm multi-fit trap.

#### PACKAGING:

Dimensions: 1140 x 430 x 390 mm

Weight: 33 kgs

# CAUTION

## Drinking Fountains On Outside Locations

During winter when temperatures may reach freezing point, it is advisable to drain the water system to prevent damage to the bubbler cartridge.

Ideally, a drain-cock should be fitted downstream of the shut-off cock and before the fountain.

To drain the system:-

1. Close off the shut-off cock and drain off at the drain-cock holding the push button in the open position until all the water has drained away.
2. Close off the drain-cock.

If a drain-cock is not available, the water can be drained in the same manner at the removable plug on the line strainer located inside the fountain.

Please note that frequent use of this item for draining purposes can lead to leakages and it should be considered as a temporary measure until such time that a drain-cock can be fitted.



### *Water Flow Adjustment*

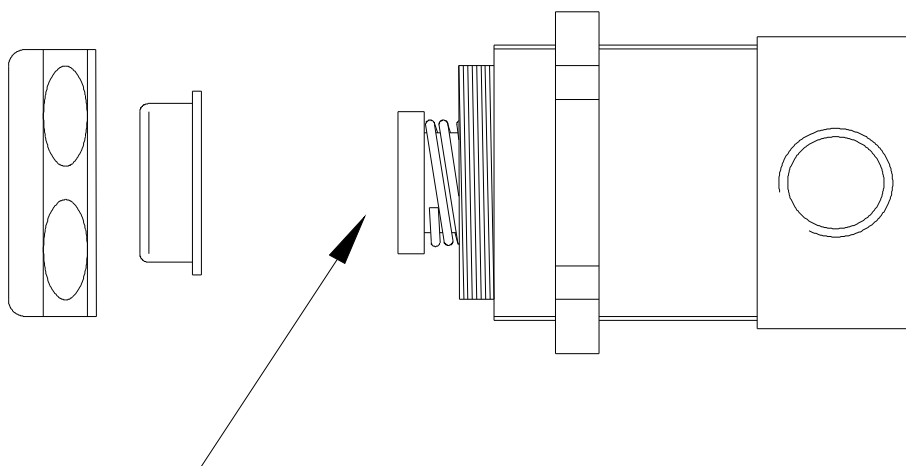

**ADJUST THE WATER FLOW BY ROTATING THE SLOT IN THE  
WHITE HEADED SCREW LOCATED IN THE PUSH BUTTON**