



# MAESTRO Pressure Coolers

11/17 Powerscroft Road, Sidcup, Kent. DA14 5NH

**Maestro**

Telephone: 020 8302 4035 Fax: 020 8302 8933

E-mail: [sales@maestrointl.co.uk](mailto:sales@maestrointl.co.uk)

Website: [www.maestrointl.co.uk](http://www.maestrointl.co.uk)

Water Coolers \* Drinking Fountains \* Bottled Water Deliveries \* Accessories \* Sanitization

## DRINKING FOUNTAIN MODEL F243

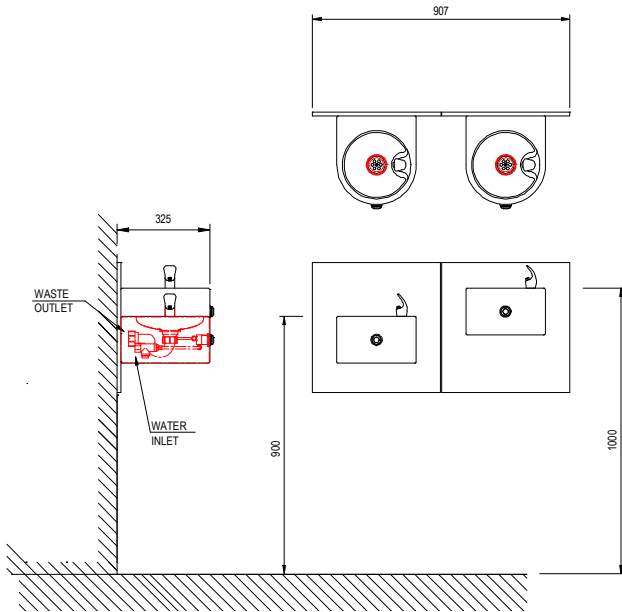

### Suggested Specification:

Contractor will supply Twin semi-circular wall-mounted fountains fabricated in stainless steel with splash-back panels in Hi/Lo formation. The fountains will have remote push-button regulator in the front operating a chrome-plated projector. The access plate will be fixed with tamper-proof bolts. **The fountain will be Maestro model F243**

### General Description:

Twin stainless steel semi-circular drinking fountains with projector activated by a remote push button.

### Services:

Water inlet: 15 mm (1/2" BSP) brass line strainer  
Waste: 32 mm multi-fit trap.

### CONSTRUCTION:

Pressed stainless steel twin fountains designed in Hi/Lo formation each with contoured basin.



Specifications subject to change without notice



# CAUTION

## Drinking Fountains On Outside Locations

During winter when temperatures may reach freezing point, it is advisable to drain the water system to prevent damage to the bubbler cartridge.

Ideally, a drain-cock should be fitted downstream of the shut-off cock and before the fountain.

To drain the system:-

1. Close off the shut-off cock and drain off at the drain-cock holding the push button in the open position until all the water has drained away.
2. Close off the drain-cock.

If a drain-cock is not available, the water can be drained in the same manner at the removable plug on the line strainer located inside the fountain.

Please note that frequent use of this item for draining purposes can lead to leakages and it should be considered as a temporary measure until such time that a drain-cock can be fitted.



### *Water Flow Adjustment*

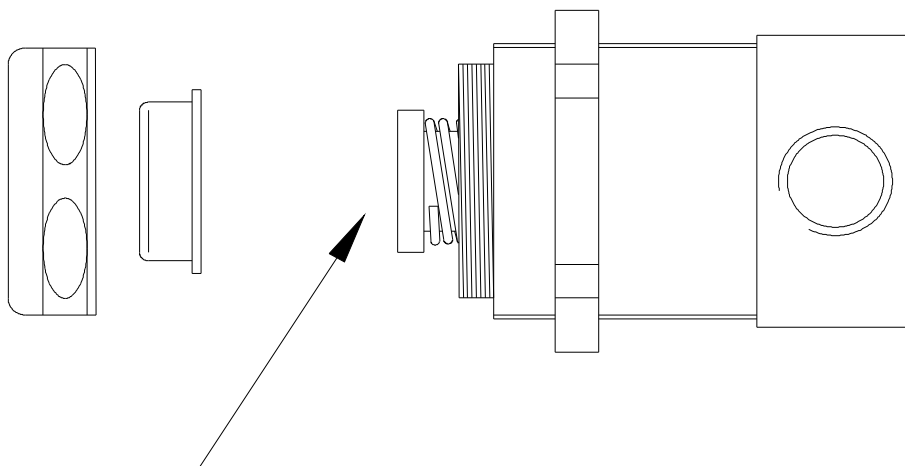

**ADJUST THE WATER FLOW BY ROTATING THE SLOT IN THE  
WHITE HEADED SCREW LOCATED IN THE PUSH BUTTON**